

## Integrating ANPR License Plate Recognition Camera Comprehensive Reporting and Analytics for Smart Car Parking Access Control

### Basic Information

- Place of Origin: China
- Brand Name: SEWO
- Certification: CE IS09001
- Model Number: SEWO-CP9
- Minimum Order Quantity: 1 lane
- Price: Negotiable
- Packaging Details: wooden box
- Delivery Time: 5-7 working days
- Payment Terms: T/T, Western Union, MoneyGram, L/C, D/A, D/P
- Supply Ability: 2000 sets per month



### Product Specification

- Product Name: License Plate Recognition Camera
- Communication: Base RS485. Rear TCP/IP
- Housing Material: Steel & Tempered Glass
- Housing Color: Black
- Communication Transmission Distance: 1200m(RS485)
- Integration: Compatible With Existing Parking Systems
- Accuracy: 90%+
- Data Analysis: Advanced Data Analytics For Parking Optimization
- Functionality: Real-time Vehicle Detection And Identification
- Application: Parking Management
- Camera Type: High-resolution Cameras With Infrared Capabilities
- Security: Secure Data Encryption And Storage





## Product Description

### Smart Car Parking Access Control With ANPR License Plate Recognition Camera

#### Discriptions of SEWO License Plate Recognition Camera Parking System:

ANPR/LPR/ALPR car parking management system is Automatic Licence Plate Recognition System. Research on automatic licence plate recognition ( ALPR ) system involves many fields of techniques, such as data mining, computer vision, pattern recognition, artificial intelligence, automation, digital image processing and so on. The objective of automatic vehicle number plate recognition system is to accurately extract and recognize the vehicle number plate from the complicated background.

#### Advantage of SEWO CP9 ALPR Parking System:

- 1, The SEWO ALPR system supports licence plate types: Singapore, Malaysia, Vietnam, Thailand, Indonesia, Canada, Japan, Saudi Arabia, Chile, India, Turkey, Angela, Taiwan, Hongkong, Macao and over 100 countries and regions .
- 2, The SEWO ALPR parking equipment can operate without Internet or computer: Regular vehicle data stored in memory in advanced.
- 3, The SEWO ALPR parking equipment supports video streaming and trigger recognition: Trigger Recognition without install induction coil , and system can set the virtual coil position.
- 4, Outdoor LED Display(Optional): can display vehicle information, charging information, time and date, announcement information, parking space, etc.
- 5, LED fill light can automatically fill light according to scene changes to ensure vehicle passing rate.
- 6, The system can combine the verification mode of IC/ID card with license plate.
- 7, Simple, perfect, accurate and efficient.

#### SEWO License Plate Recognition Parking System

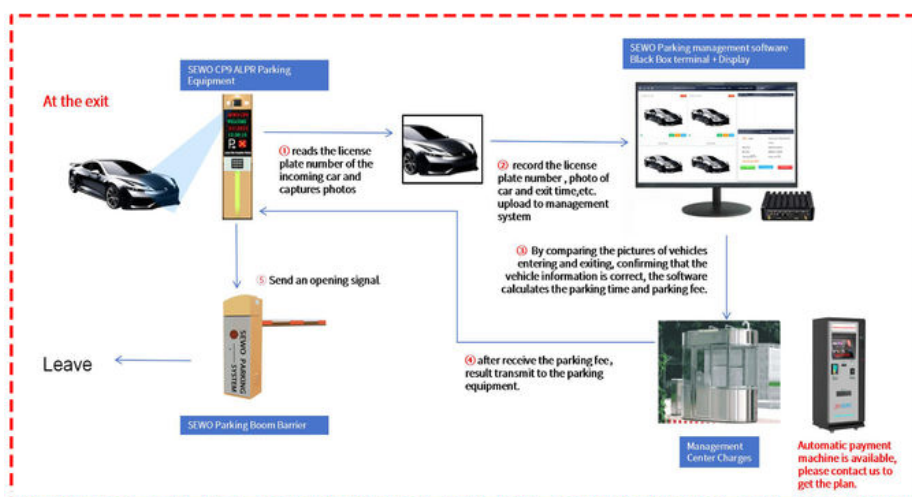
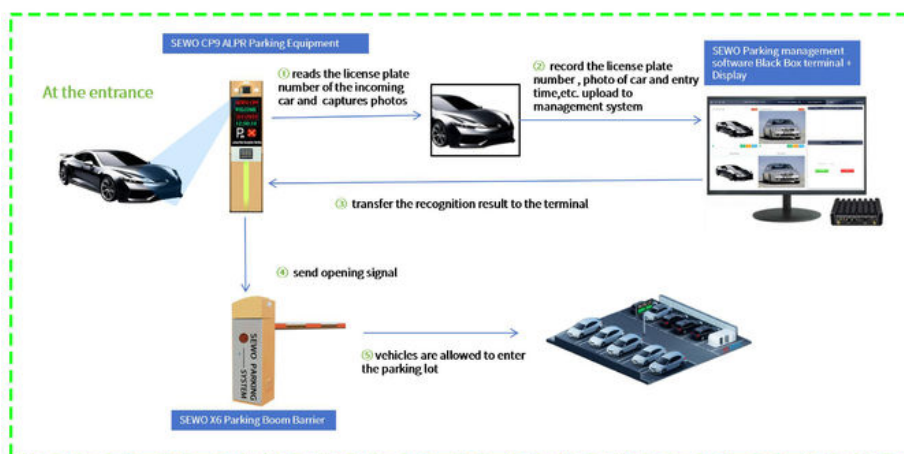

#### Specifications of CP9 Smart Parking System:

Product Name	SEWO-CP9
Housing Material	Steel & Tempered glass
Housing Color	Golden, Gray
Mode of Communication	Base RS485. Rear TCP/IP
Communication Transmission Distance	1200m(RS485)
Data Transmission Speed	4800bps/100m
Offline Storage Capacity	10000pcs(Extendible)
Blacklist Capacity	1000pcs(Extendible)
Working Temperature	-30 --70



## Vehicle & Pedestrian Access Control Management

# SMART PARKING SYSTEM

# CHINA top10

## COMPANY CERTIFICATION





# Why Choose US?

Focus on the Vehicle Access Control **22 years**



## Embedded License Plate Recognition Algorithm

- ✓ **Fast Recognition Speed**  
Image acquisition, processing and recognition are completed locally directly through embedded algorithms
- ✓ **High Comprehensive Recognition Rate**  
The comprehensive recognition rate of license plate recognition in most countries has reached over 97%.
- ✓ **Simple Equipment Installation**  
The system can operate independently, with low failure rate and controllable maintenance cost.



## Traditional License Plate Recognition

- ✗ **Slow Recognition Speed**  
relies on network transmission, prone to delays during peak hours.
- ✗ **High System Complexity**  
usually relies on industrial computers for image processing and algorithm calculations
- ✗ **High Maintenance Cost**  
traditional systems require industrial computers, servers and network facilities, with long deployment cycles and high costs



# multiple functions

Easily solve 99.8% of common parking lot problems



**User Rights  
Management**



**Voice  
Announcements**



**Vehicle Record  
Query**



**Rapid  
Identification**



**Offline Running**



**Temporary Vehicle  
Management**



**VIP User  
Management**



**Blacklist  
Management**



**Traffic  
management**



**On-line Monitor**



**Multiple Payment  
Methods**



**Discount Coupon  
Management**



**Simple  
Installation**



**Smooth  
Operation**



**Strong  
Compatibility**



**Customizable  
Software**



Clear identification | Rapid identification

# 3 million pixel

## HIGH-DEFINITION RECOGNITION CAMERA

Supporting over 100 countries or regions

Algeria, America, Angola,  
Argentina, Australia, Austria,  
Bahamas, Belgium, Belize,  
Bolivia, Brazil, Bulgaria,  
Burundi, Canada, Cayman Islands,  
Chile, Colombia, Congo,  
Costa Rica, Croatia, Cuba, Cyprus,  
Czech Republic, Denmark,  
Dominican Republic, Ecuador,  
El Salvador, Estonia, Finland,  
France, Germany, Greece, Guyana,  
Honduras, Hungary, India,  
Indonesia, Ireland, Israel,  
Italy, Jamaica, Japan, Kazakhstan,  
Kenya, Kyrgyzstan, Latvia,  
Lithuania, Luxembourg, Madagascar,  
Malawi, Malaysia, Malta, Mexico,  
Mozambique, Netherlands,  
Nicaragua, Nigeria, Panama,  
Paraguay, Peru, Philippines,  
Poland, Portugal, Puerto Rico,  
Romania, Russia, Rwanda,  
Sao Tome, Senegal, Serbia,  
Seychelles, Singapore, Slovakia,  
Slovenia, South Africa, Spain,  
Suriname, Sweden, Tajikistan, Tanzania,  
Thailand, Togo, Turkey, Turkmenistan,  
Uganda, United Kingdom, Uruguay,  
Uzbekistan, Venezuela, Vietnam,  
Zambia, Zimbabwe, Hong Kong (China)  
Taiwan(China) .....





# offline running

When the system is offline or disconnected from the internet, our license plate recognition camera can still work normally



high-frequency cable

Reader





# SEWO Parking Management System Solution Diagram

Free on-site engineering design proposal

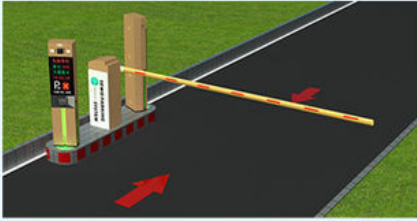

One Lane for Entrance and Exit  
(SEWO CP9 + Boom Barrier)



Two Lanes : One Entrance + One Exit  
(SEWO CP9 + Boom Barrier)



Two Lanes : One Entrance + One Exit  
(SEWO CP9 + Advertising Boom Barrier)



Two Lanes : One Entrance + One Exit  
(SEWO CP9 + Ticket Parking Equipment)

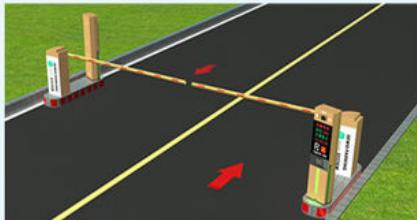

Two Lanes : One Entrance + One Exit  
(SEWO CP9 + Boom Barrier)

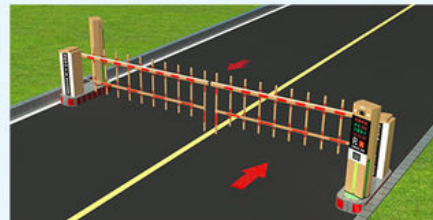

Two Lanes : One Entrance + One Exit  
(SEWO CP9 + Fence Boom Barrier)

## factory scene

Welcome to visit our factory







#### FAQ

1, What is the strength of your company in this industry?

Our company pays much attention to bringing and developing new technique and products since the foundation in 2003. Our brand "SEWO" has ranked among the top 10 famous brands of car parking systems and facilities in China.

2, What is the advantage products of your company?

Shenzhen Sewo Technology Ltd. Is a professional high-tech enterprise, which integrates the development, manufacturing, marketing, and service of Smart Parking Management System, Flap Barrier, Tripod Turnstile, Swing Gate, Parking Guidance System, Barrier Gate, Parking Lock, Access Control Systems and other related security products.

3, How about the quality of your product?

With our exquisite technology and strict quality testing system, we passed "CE" and "ISO9001:2008" international quality assessment standards. Our company also has won many honors, such as "China Top 10 Parking Management System Supplier", "AAA grade quality, service and prestige enterprise in China", and so on. Professional R&D team has strong capacity to be committed to continuously creating high quality products and service.

4, How about some customization request?

We support OEM / ODM service, more than 20 years industry experience will bring appropriate design for you, not only products, but also a smart access management solution expert.

5, Do you have agency for after-sales service?

Any question about products, you can find our sales anytime. We will provide life-time technology support. We have established many branch offices and gained much agents at home. Our sales and service network spreads all over the world. We also have extensive sales channels in Southeast Asia, the Middle East, Africa, Europe, and America. We warmly welcome customers or agents all over the world to join us to construct an intelligent, safe, convenient and harmonious society.

6, How about the delivery time?

Regular products need 5-10 working days.

The delivery time of customized products is according to your requirement.





+86 18128807893



sewo198@szsewo.com



turnstilebarriers.com

Busha Road No 231. Buji Street. Longgang District. Shenzhen. China